

Automatic[™] **FENDER**

Automatic Fender Care and Operation Instructions



The Automatic Fender™ eliminates the need to climb onto the Bow to deploy fenders, significantly reducing the risk of falling or injury while docking! Now you can dock without leaving the cockpit, improving safety and eliminating hassle.

WARNING

Your Boat may pull the fenders with a very significant force that creates tension on the fender line and may cause serious injury, particularly if a body part is wrapped in the line.

USE THE AUTOMATIC FENDER SAFELY:

Stay clear while docking. Keep yourself and others away from the Automatic Fender while docking.

Do not touch the Automatic Fender while in operation. Make sure no one touches or pulls on any part of the Automatic Fender while it deploys or lifts.

Do not attempt to repair, open, or modify.
All repairs must be done by Boat Innovation® only.

Before docking, always verify that the fenders are deployed to the desired height and position/angle.

Do not use in rough weather.
Do not exceed the product's maximum ratings.

BATTERY WARNINGS

This unit contains a battery pack:

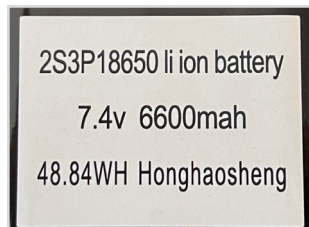

AUTOMATIC FENDER BOX CONTENT, PER PRODUCT:

- An Automatic Fender
- 6 bolts and 6 nuts, spare bolt & nut
- 3 pairs of clamps
- 3 bushings and bolt covers
- Instruction manual
- Spacer kit



For the installation video, scan the QR with your phone's camera:
www.automaticfender.com/qrcode

SCAN THIS:



Please contact us with any questions that you may have at: support@BoatInnovation.com or +1-925-418-2448. Please add support@BoatInnovation.com to your contacts.

INSTALLATION TOOLS

- A P4 Screwdriver, a tape measure and a ½" Wrench.
- Only use a large head (P3 or P4) Phillips screwdriver. **Do not use an electric screwdriver or any other power tool**, as the bolts and nuts are stainless steel and may get welded together.



IDENTIFY THE PORT VS STARBOARD AUTOMATIC FENDER

On the bottom of each Automatic Fender please find a label specifying its planned location:



On the sticker: first line specifies Bow vs Mid Ship vs Stern (in a single pair purchase, please disregard). Second line specifies Port vs Starboard. Please install accordingly to make sure the application matches the physical location of each Automatic Fender:



PORT SIDE INSTALLATION

Start with the Port Automatic Fender installation. The Automatic Fender should be installed to the right of the fender, towards the Stern:

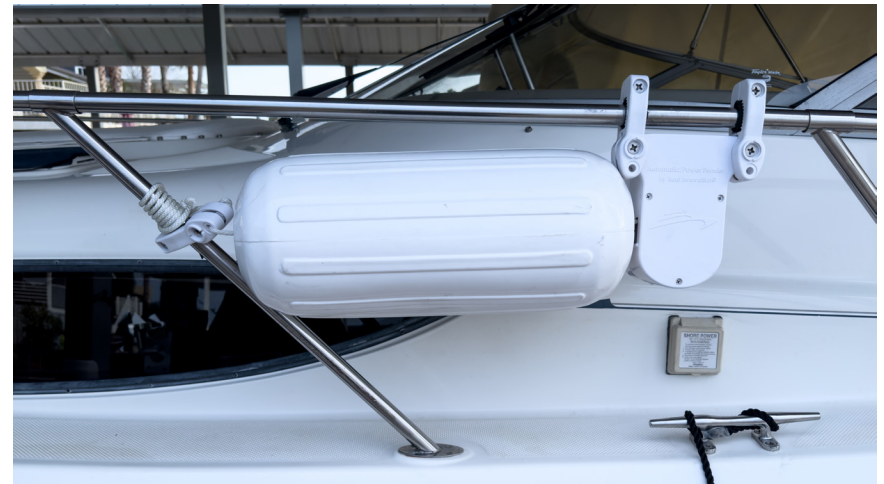

The Automatic Fender line must always wrap over the pulley (from the top), if it wraps from the bottom please refer to troubleshooting:



SPACER INSTALLATION (AS NEEDED)

In some cruisers the railing is significantly recessed relative to the Rub rail:



If your cruiser's railing is recessed more than 4" relative to the Rub rail, please add the provided spacer. The spacer allows installation closer to the Rub rail by extending the Automatic Fender out from the railing. Add the spacer between the Automatic Fender and the clamp, using the long bolt:



CLAMP INSTALLATION

We will continue the installation assuming a spacer is not required. In case a spacer is required, please add it at each of the following steps.

Connect a clamp to the Automatic Fender using a single bolt and a single nut.



Tighten the bolt only **Lightly**:



If the clamps are too wide, add the provided bushings. Trim the bushings as needed (often only half is needed).



Install the Automatic Fender just in front of the stanchion (towards the Bow). Tighten the bolts only **lightly** to allow clamp movement along the railing during the installation:



For unique installations and Q&A please check our website:
automaticfender.com/support

SCAN THIS:



Install the second clamp:

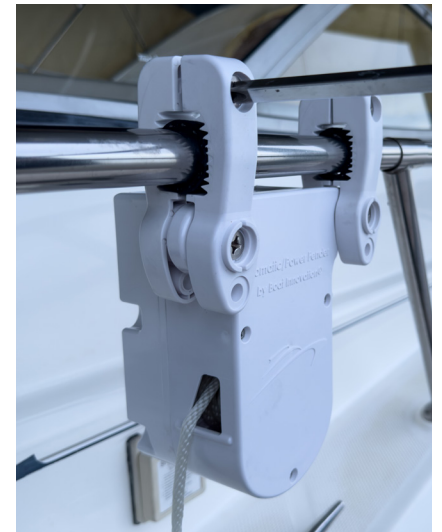



If the Boat has a **lifeline**, it should be placed under or behind the **Automatic Fender**.



Make sure the lifeline is fully tightened and doesn't interfere with the fender's movement.

Always make sure that the nuts are fully inserted into the Automatic Fender's clamp.

Proper nut placement:



Note: The nut lock is to the outside. The nut is fully inserted into the plastic groove.

Wrong placement, Nut is not fully inserted:



For installation Video, scan the QR with your phone's camera:
www.automaticfender.com/qrcode

SCAN THIS:



FRONT CLAMP INSTALLATION

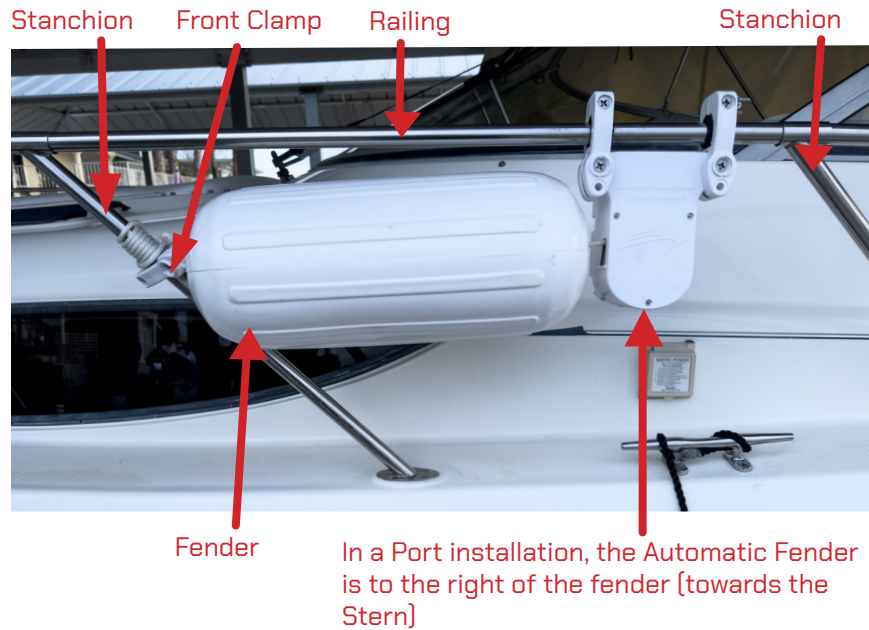

Loosely install the front clamp about 8" below the railing. Tighten the bolts only lightly and evenly. Accurate positioning is **not** important at this stage; positioning will be adjusted later.



Remove the rubber band from the line, and run it through the fender's center hole:

Make sure the fender is properly inflated, flat fenders may get stuck on the rub rail!



Insert the line from the outside in, towards the Boat, through the front clamp's small hole.



To support a railing height of up to 9', the Automatic Fender comes with an 18' line. The average cruisers railing height is about 5.5'.

We will now pull out the extra line through the front clamp.

Place the fender on the water, and pull the line that went through the front clamp hole until one side of the fender is lifted ~ 3 inches from water level.



Tie a knot on the line that went through the front clamp hole:



Pull the line firmly while holding the front clamp, and confirm that the knot doesn't slip out through the clamp hole. Wrap the extra line around the stanchion and secure it:



Install remaining Port, and then all Starboard Automatic Fenders in the same manner. In a starboard installation the Automatic Fender is left to the fender, towards the stern. **The Automatic Fender line must always wrap over the pulley (from the top):**



TROUBLESHOOTING

SCAN THIS:



In case of a problem or a special installation, please refer to troubleshooting at: automaticfender.com/support
Or call us: + 1 (925) 418 2448.

THE BOAT INNOVATION APPLICATION

Use or configure the application only after installing ALL PORT AND STARBOARD Automatic Fenders and the fenders on the boat by following all installation steps. Configuring the application before fully installing all Automatic Fenders may tangle the line and cause a malfunction.

Internet connectivity is required through the configuration stage.

SCAN THIS:



Download the **Boat Innovation** application from the Apple or Android stores. You can also find a link on our web site: automaticfender.com/support

Certain features of the application require access to Location services. When prompted please select “While using the app”, otherwise the application will not work properly. As an example, location services enable notification if fenders are deployed while accelerating.
Note: we do not sell or share any information.

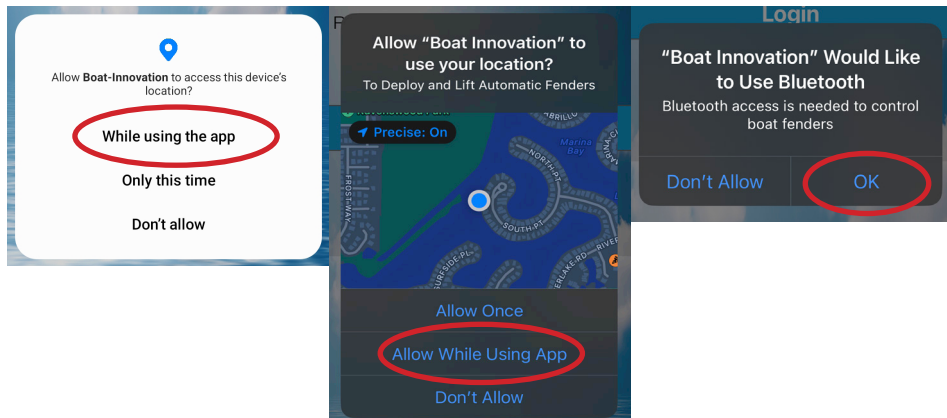

SAFETY: THE STOP BUTTON

Pressing on the “**Stop All**” button or quitting/closing the application will stop all fender movement. Please use this button as needed.



CONFIGURATION

Enter the email address provided at purchase; the default password is: Innovation
The password is case sensitive.

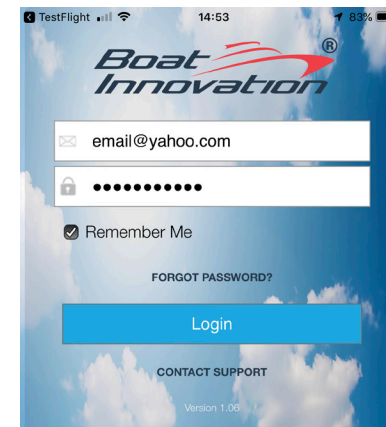

At first login, the application will direct you to the configuration page. You can always get to the configuration page through the main menu, by choosing the hamburger menu icon on the top right corner of the mobile screen, and then selecting the “**Configuration**” page from the drop-down menu:

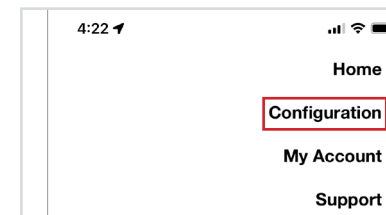

Configuration Page:

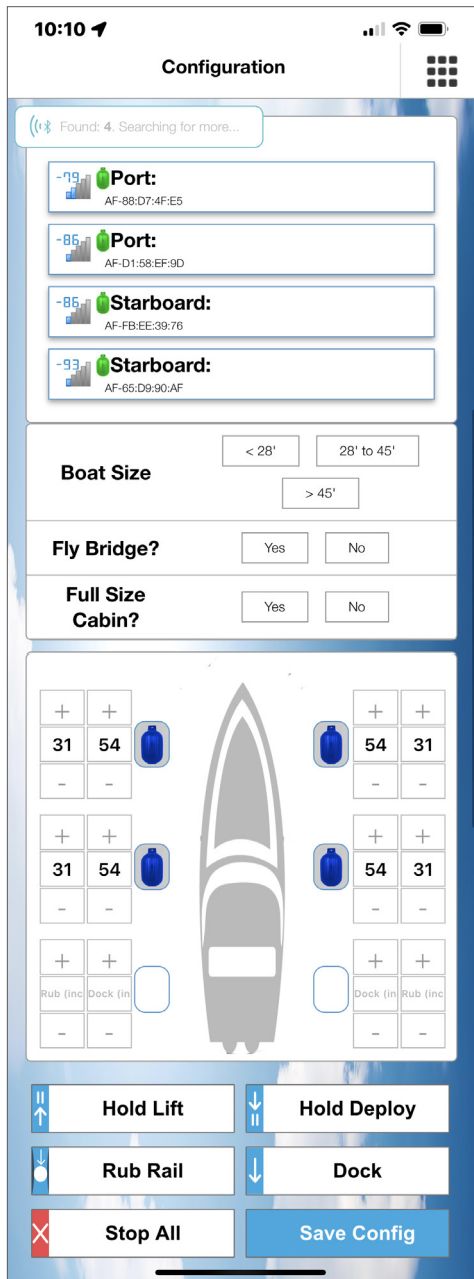

To provide the best customer service, we need some information about your boat:

Boat Size	< 28'	28' to 45'	> 45'
Fly Bridge?	Yes	No	
Full Size Cabin?	Yes	No	

Confirm that the Automatic Fenders are connected:

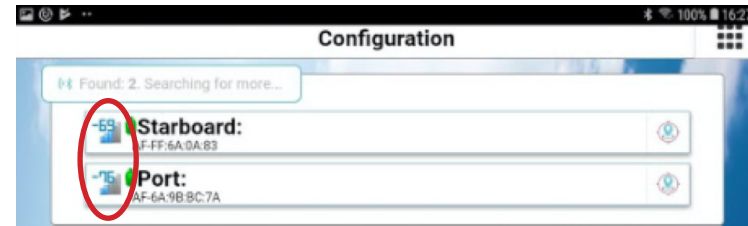

If the Automatic Fenders are not connected, the application will show:

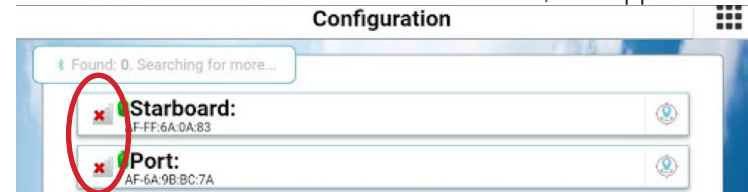

In that case, refer to troubleshooting at: automaticfender.com/support

Get the fender to its lift position:

Select a fender by pressing a fender icon . The selected fender will turn green .

Press and hold “Hold Lift”; until the line is tight and the fender stops moving up.



Do not use “Dock”, “Rub Rail” or “Lift” until the installation is complete, as it may cause serious injury, particularly if a body part is wrapped in the line!

You can always release line by pressing and holding “Hold Deploy”.

Move the bottom of the Automatic Fender outwards until it is beyond the Bow line. Make sure it is not exceeding the Rub rail line:



The small hole of the front clamp should be facing out at 45 degrees, the line inserted from the outside.



Move the front clamp up or down the Stanchion until the fender is parallel to the railing:



While the fender is touching the Automatic Fender:

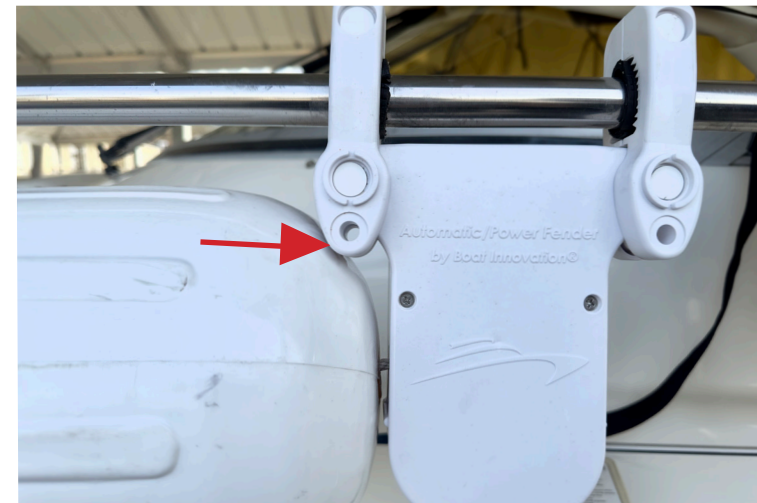

The distance between the other side of the fender to the front clamp should be about 4 inches [5cm]. Move the Automatic Fender along the railing to achieve the desired location:

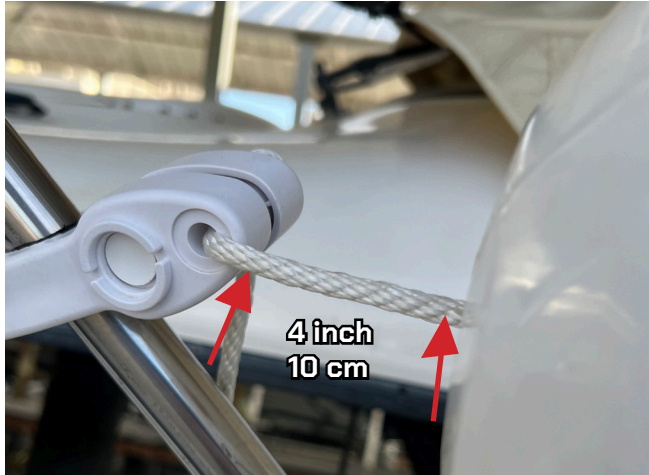

Too little of a distance between the front clamp and the fender, may cause the fender to get stuck and not deploy properly. If the fender is stuck, the rope may get tangled.

DEPLOYING

Make sure the fender is uninterrupted while being deployed. The fender shouldn't stop on the boat's walkway or any other undesired location. An interrupted fender will cause line tangling. In such a case the fender may go up while it's deploying.



TIGHTEN THE BOLTS

First tighten all lower Automatic Fender bolts.

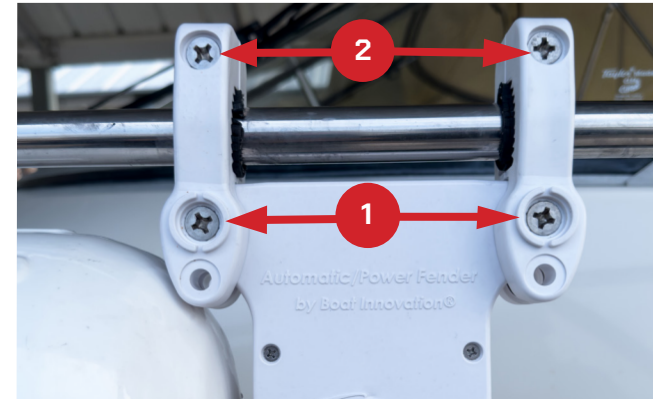

After tightening all lower bolts, tighten the top bolts in all clamps. Repeat for all Automatic Fenders.

CONFIGURING RUB RAIL HEIGHT

From this point on make sure no one touches or pulls on any part of the Automatic Fender while it deploys or lifts.

Select a fender  and press on "Rub Rail".

The selected fender will be lifted all the way to the rail, and will perform a few short movements to confirm reaching the railing.



Then it will deploy to the default Rub rail level.



Adjust to the desired height by pressing + or - on the Rub rail line length:

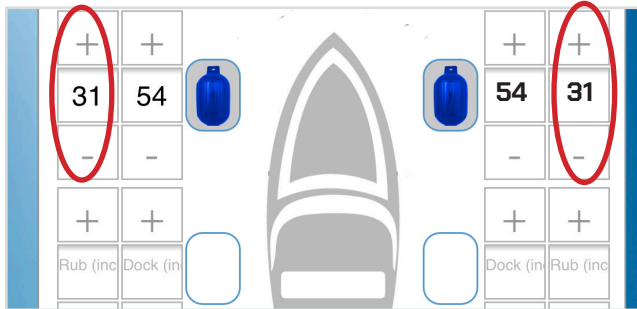

Press **“Rub Rail”** again to test the new line length.
Repeat these steps until the desired Rub rail line length has been achieved.

If the fender doesn't deploy in a consistent manner, refer to the troubleshooting document at automaticfender.com/support

CONFIGURING DOCK HEIGHT

Select a fender  and press on **“Dock”**:



The selected fender will be lifted all the way to the rail, and will perform a few short movements by the rail, before deploying to the default dock level.

Adjust to the desired height by pressing + or - on the dock line length:



Repeat until desired length.

CONFIGURING ALL AUTOMATIC FENDERS

Repeat these steps for each Automatic Fender.

SAVE CONFIGURATION

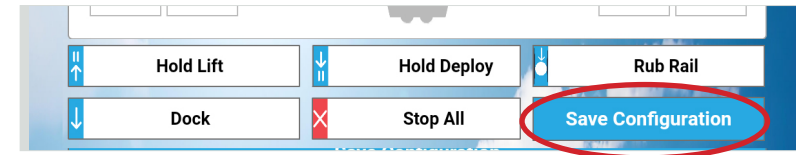

TESTING AND ENJOYING THE AUTOMATIC FENDERS

From the main menu , choose the **“Home”** page and test the different functionalities:

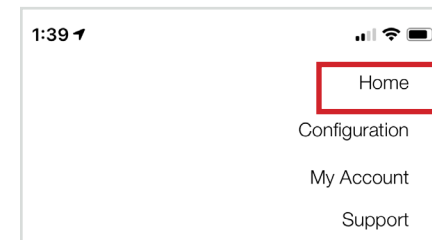

Press **“Lift”** and confirm that all fenders are lifted to rail level.

Press **“Dock Deploy”** to lower to dock height. Repeat the configuration stage if necessary.



Before docking always confirm that the fenders are deployed to the correct height, and adjust line length if needed.

It is always best to deploy the fenders in calm waters (when entering the marina). Fenders deployed too early in choppy waters may change to a horizontal angle.

You can always change them back to vertical deployment by lifting and deploying again.

Press “Lift” again to lift the fenders to rail level.

Press “Dock Deploy” to deploy to dock height. Repeat the configuration stage if necessary.

Press “Toggle View” to switch between control and hybrid view:

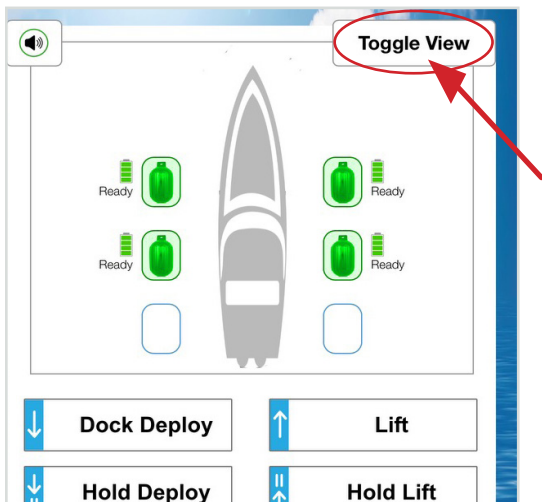

CHANGING THE PASSWORD

From the main menu , choose “My Account”. Change the password from the default (Innovation) to your desired password.

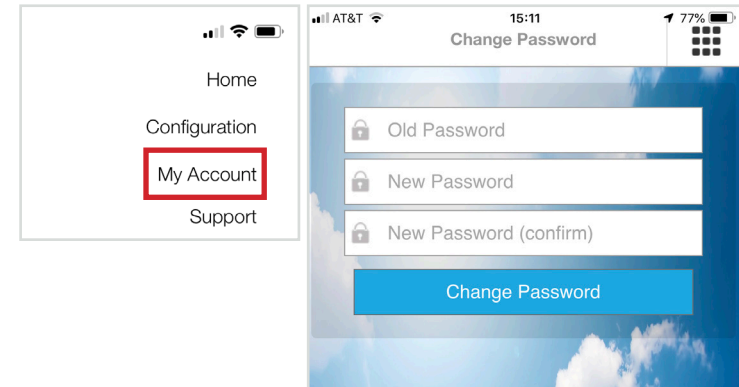

My new Password is: _____

SUPPORT AND TROUBLESHOOTING

From the main menu , choose the “Support” page. Use this page to send us questions, feedback on problems, improvement ideas and any additional comments you may have.

You are welcome to call us at: 925-418-2448 [California, USA].

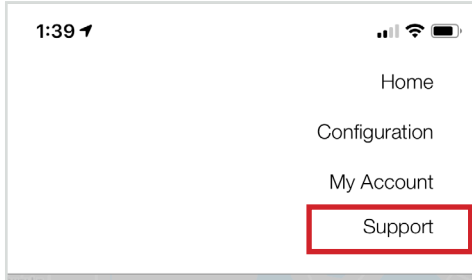

Scan me for Support :



For troubleshooting, send us an email from the **application's** support page. To send us an image or video showing the problem, please email us directly: support@boatinnovation.com

You can find useful troubleshooting tips on our website: automaticfender.com/support

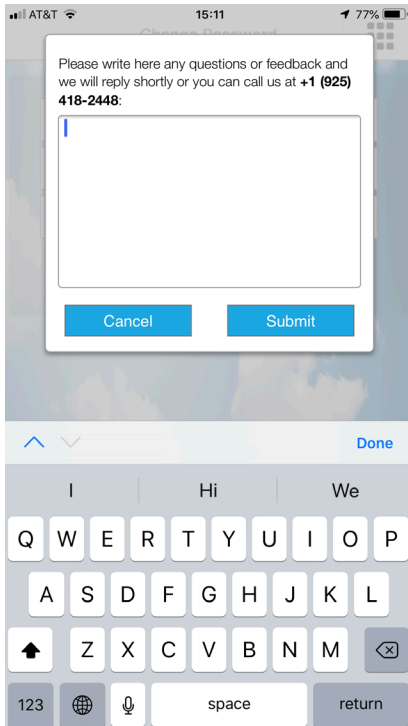

SUSPENDING FENDER MOVEMENT

To disable movement on any given fender, press the fender icon .

A suspended fender will show as gray  and will not react to commands. To activate a suspended fender, press on the fender icon again.

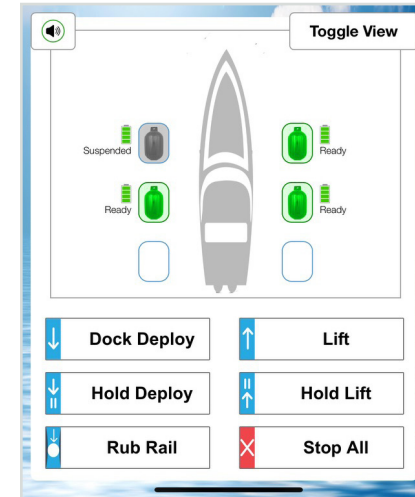

CARE AND MAINTENANCE

To keep the Automatic Fender white and shiny for years to come, polish and wax all white Automatic Fender surfaces. Use marine boating approved polishing and waxing products. If the boat is normally docked in a covered area, waxing and polishing every other year is sufficient. If the boat is not normally docked in a covered area, waxing and polishing should be done twice a year.

The solar cells should not be polished or waxed, please keep them clean using only a cloth and water.

BOLT COVERS & FRONT CLAMP LINE

Install the bolt covers only after your first cruise using the Automatic Fenders, and after one last bolt tightening:



For installations using spacers:



Cut off the extra line wrapped on the Stanchion :

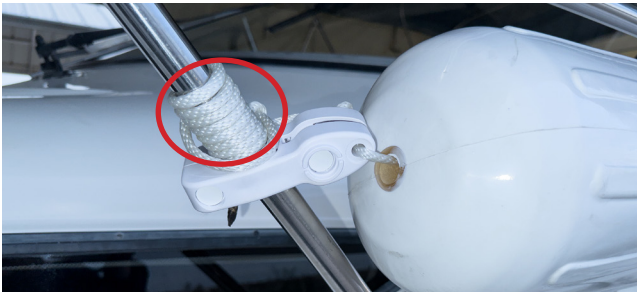

We highly appreciate reviews with pictures on [Google](#). To show our appreciation, we will extend your valid warranty by one additional year for FREE!!!

Scan me to review:



Thank You!

Thank you for your Automatic Fender purchase!

To help your friends and family with their safe boating adventures, we offer an exclusive \$50 discount on their Automatic Fender set purchase! They can use this promo code at checkout: ThankYou



Updated: November 16, 2023 5:03 PM